

NORTHCOTE TOWN HALL - MAIN HALL

1:115 Scale

LENGTH: 24m (curtain to end of hall)

WIDTH: 13.8m **CAPACITY:** •400 seated theatre • 250 Banquet function

HEIGHT: 9.5m **NOTES:** 330m2 •wheel chair accessible •wooden floorboards •west wing kitchen •heaters •blinds

Light Switch

Power Point

3-Phase Outlet

Trestle Table
(for reference)

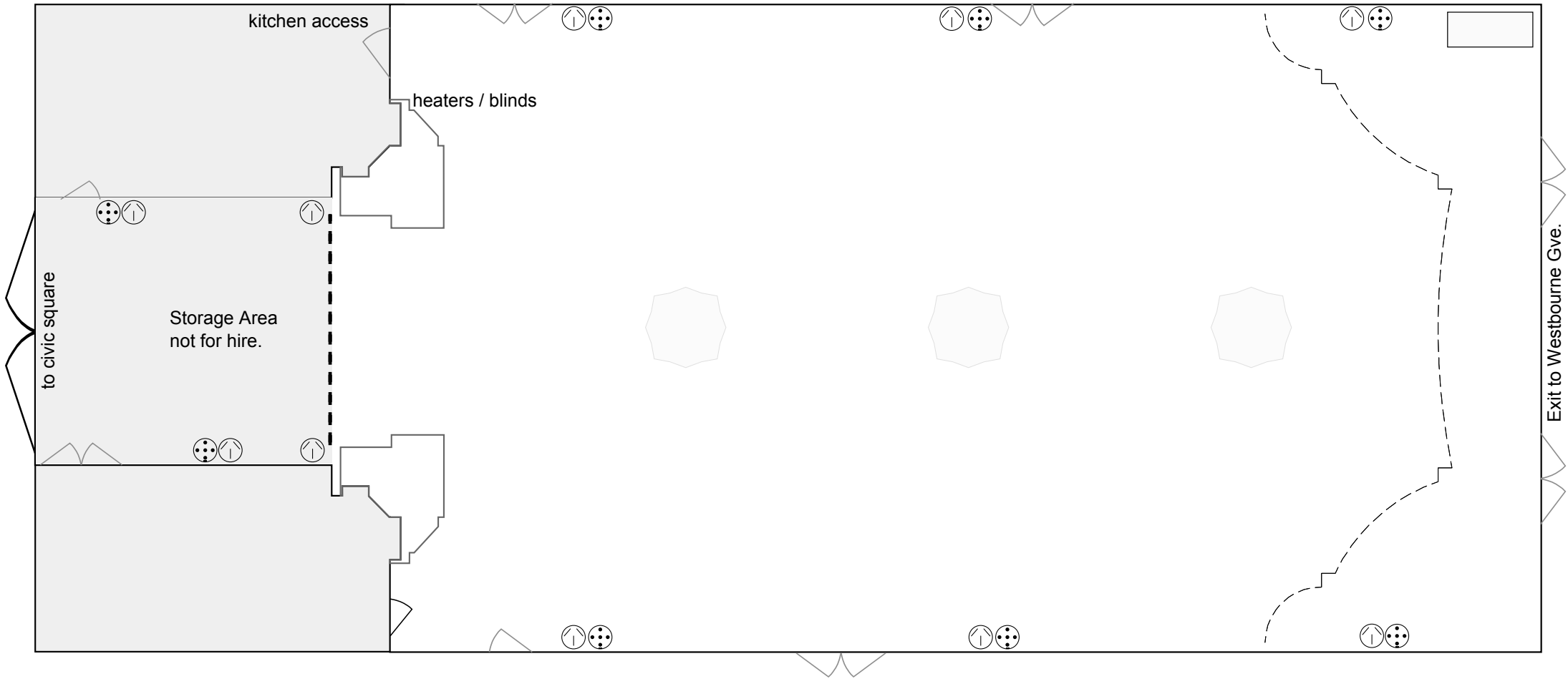

Main Entrance / Exit to Foyer

Lights for the hall are controlled from Store room A (next to hall)